

**PROJECT LOCATION**

BEGIN PROFILE STA. 26+65.86

CR 252 (TRIMBLE LANE)

END PROFILE STA. 39+14.27

COUNTY ROAD 500

COUNTY ROAD 200

LPC PROJECT NO. 2023-036

Sheet List Table	
Sheet Number	Sheet Title
1	COVER SHEET
2	CONSTRUCTION NOTES
3	TYPICAL SECTION
4	SITE PLAN
5	EROSION CONTROL PLAN
6	PPRO STA 26+50 TO STA 30+00 A
7	PPRO STA 30+00 TO STA 34+00 B
8	PPRO STA 34+00 TO STA 39+25 C
9	PAVEMENT MARKING AND SIGNAGE PLAN
10	CROSS SECTIONS A
11	CROSS SECTIONS B
12	CROSS SECTIONS C

## SUPPLEMENTAL PLANS

### 1. VILLAGE CAMP DURANGO

APPROVED:

ANIMAS WATER COMPANY

ATE

APPROVED:

HERMOSA SANITATION DISTRICT

ATE



I HEREBY CERTIFY THAT THIS PLAN WAS PREPARED BY ME OR UNDER MY DIRECT SUPERVISION AND THAT I AM A DULY LICENSED PROFESSIONAL ENGINEER UNDER THE LAWS OF THE STATE OF COLORADO.

PROJECT NO.
168892

Signature \_\_\_\_\_ DAN PONDER

Date: 08/04/2023 Lic. No. 0052406

1  
of 12

	RIGHT OF WAY
	PERMANENT EASEMENT
	PROPERTY LINE
	HORIZONTAL CONTROL POINT
	BENCHMARK
	SURVEY MARKER
	SOIL BORING
	SANITARY SEWER AND MANHOLE
	FORCE MAIN AND LIFT STATION
	SANITARY SEWER SERVICE & CLEANOUT
	WATER MAIN, HYDRANT, VALVE AND MANHOLE
	WATER SERVICE AND CURB STOP BOX
	STORM SEWER, MANHOLE AND CATCH BASIN
	CULVERT AND APRON ENDWALL
	GAS MAIN, VALVE, VENT AND METER
	HANDHOLE
	BURIED FIBER OPTIC CABLE AND MANHOLE
	BURIED PHONE CABLE, PEDESTAL AND MANHOLE
	BURIED TV CABLE, PEDESTAL AND MANHOLE
	BURIED ELECTRIC CABLE, PEDESTAL, MANHOLE, TRANSFORMER AND METER
	OVERHEAD WIRE, POLE AND GUY WIRE
	LIGHT POLE
	TRAFFIC SIGNAL
	STREET NAME SIGN
	SIGN (NON STREET NAME)
	RAILROAD TRACKS
	DECIDUOUS AND CONIFEROUS TREE
	BUSH / SHRUB AND STUMP
	EDGE OF WOODED AREA
	WETLAND
	BUILDING
	FENCE (UNIDENTIFIED)
	BARBED WIRE FENCE
	CHAIN LINK FENCE
	ELECTRIC WIRE FENCE
	WOOD FENCE
	WOVEN WIRE FENCE
	PLATE BEAM GUARDRAIL
	CABLE GUARDRAIL
	POST / BOLLARD
	RETAINING WALL
	STREET CENTERLINE
	RIGHT-OF-WAY
	PERMANENT EASEMENT
	TEMPORARY EASEMENT
	CONSTRUCTION LIMITS
	SANITARY SEWER, BULKHEAD AND MANHOLE
	FORCE MAIN
	SANITARY SERVICE AND CLEANOUT
	WATER MAIN, TEE, HYDRANT, BULKHEAD AND VALVE
	WATER VALVE MANHOLE, REDUCER, BEND AND CROSS
	WATER SERVICE AND CURB STOP BOX
	STORM SEWER, MANHOLE AND CATCH BASIN
	CULVERT AND APRON ENDWALL
	DRAIN TILE
	DITCH / SWALE
	RIPRAP
	STREET NAME SIGN
	SIGN (NON STREET NAME)
	RETAINING WALL

UTILITY LIST:

THIS LIST IS FOR GUIDANCE ONLY D MAY NOT BE COMPLETE. UTILITY LOCATION IS THE RESPONSIBILITY OF THE CONTRACTOR PRIOR TO THE START OF CONSTRUCTION.

ALLTEL FIBER OPTICS  
970-247-3111  
ATMOS ENERGY  
970-259-7651  
LA PLATA ELECTRIC  
970-247-5786  
ANIMAS WATER COMPANY  
970-259-4788

NOTE:  
THE SUBSURFACE UTILITY QUALITY INFORMATION IN THIS PLAN IS LEVEL D. THIS UTILITY QUALITY LEVEL WAS DETERMINED ACCORDING TO THE GUIDELINES OF C/ASCE 38-02 ENTITLED "STANDARD GUIDELINES FOR THE COLLECTION AND DEPICTION OF EXISTING SUBSURFACE UTILITY DATA."

THE CONTRACTOR SHALL CALL THE ONE CALL SYSTEM AT 811 BEFORE COMMENCING EXCAVATION.



Know what's **below**.  
**Call** before you dig.

Save: 1/17/2025 10:07 AM tptlster Plot: 1/17/2025 1:02 PM \\sehic.com\panzura\p2projects\PT\ROBRE\168892\5-final-dgn\51-drawings\10-Civil\cad\dwg\sheet\_CR\_252\_Improvement\168892\_CN\_CR252.dwg

General Notes:

1. The owner shall be the responsible party during construction activities to resolve construction problems due to changed conditions or design errors encountered by the contractor during the progress of any portion of the proposed work. Any improvements constructed not in accordance with the approved plans or the approved revised plans, shall be removed and the improvements shall be reconstructed according to the approved plans at the expense of the contractor.
2. The contractor will be responsible for obtaining all permits required to conduct construction activities including but not limited to an Excavation Permit for Work in the La Plata County Right-of-Way and any dewatering permits as necessary. These permits will be incidental to the project.
3. SWMP, MHT's, CDOT Standards, and any other applicable permits to be on site at all times.
4. The contractor is responsible for project survey control.
5. The contractor shall reset all Survey Monuments disturbed during construction within 60 days of project completion.
6. The contractor shall be solely and completely responsible for conditions at and adjacent to the job site, including safety of all persons and property during performance of the work. This requirement shall apply continuously and not be limited to normal working hours.
7. The duty of the County, the owner, and the engineer to conduct construction review of the contractor's performance is not intended to include review of the adequacy of the contractor's safety measures in, on, or near the construction site.
8. Field conditions may exist that require changes to the drawings. If such conditions are encountered, standard engineering practices shall be followed, and must be approved by La Plata County, the owner and Engineer.
9. Survey information provided by Justin Bonnell, PLS, Red Mountain Surveying Durango on Colorado State Plane coordinate system.
10. A qualified superintendent, who is acceptable to the owner, shall be maintained on the work site and give sufficient supervision to the work until its completion. The superintendent shall have full authority to act in behalf of the contractor, and all directions given to the superintendent shall be considered given to the contractor. In general, the superintendent shall not be engaged in the full-time operation of equipment/machinery on the work.

Street Construction Notes:

1. With notification of the respective owner, adjust rims of all cleanouts, manholes, valve covers and survey monuments to finish grade prior to final lift paving.
2. All traffic control plans for the phases of construction shall be submitted to La Plata County traffic at least 3-days prior to intended use.
3. The contractor shall provide all lights, signs, barricades, flagmen or other devices necessary to provide for public safety in accordance with the current Manual on Uniform Traffic Control Devices.
4. The contractor shall provide ingress and egress to private property adjacent to the work throughout the period of construction and prior to beginning work shall obtain written agreement from the affected property owners impacted by this access and provide such to La Plata County at the PreCon meeting.
5. All paving equipment shall meet the requirements of the CDOT Standard Specifications for Road and Bridge Construction.
6. Subgrade to be scarified and moisture conditioned to a depth of 12 inches and recompacted according to CDOT standard specifications sections 203 & 306 to a minimum of 90% of the maximum dry density as defined by AASHTO T-180 or ASTM D1557 (modified proctor).
7. All base gravels shall be compacted to at least 95% of the maximum dry density as defined by AASHTO T-180 (modified proctor).
8. Proof-rolling is required for subgrade, Class 2, and Class 6 material after each material has been compacted and tested. The vehicle must have a loaded GVW of 50,000 pounds with a loaded single axle weight of at least 18,000 pounds. Material which is pumping or deforming must be re-worked, replaced, or modified to form a smooth, stable, non-yielding base for subsequent courses. The contractor is to contact the owner's representative and the La Plata County Engineering Dept. at 382-6379 at least 48 hours before proof-rolling.
9. Roadway construction to conform with the latest editions of the Colorado Department of Transportation (CDOT) M&S Standards and Standard Specifications for Road and Bridge Construction (including any revisions).
10. All disturbed areas to be seeded and mulched.
11. Rocks and debris shall be removed from slopes prior to seeding.

Street Construction Notes(Cont'd):

11. Diluted Emulsified Asphalt shall consist of 1 part water and 1 part emulsified asphalt. Rates of application shall be as determined by the Engineer at the time of application.
12. Excavation for compaction of bases of cuts and fills will be subsidiary to that operation and will not be paid for separately.
13. On slopes flatter than 3:1, place 2 tons/acre of straw mechanically crimped into soil. On slopes 3:1 or steeper, place soil retention blanket.
14. Apply Tack Coat (Emulsified Asphalt) between all HMA layers.
15. Backfill for drainage items shall be Structural Backfill (Class I) unless otherwise noted in the plans.

Culvert and Drainage Notes:

1. Flared end sections shall be provided for all culverts shown on plans.

Traffic Control Notes:

1. Contractor to provide a traffic control plan to the County and the engineer prior to construction.

SEH Project	168892
Drawn By	SC/CM
Designed By	DP
Checked By	SW

Rev.#	Revision Issue Description	Date

Rev.#	Revision Issue Description	Date



I HEREBY CERTIFY THAT THIS PLAN WAS PREPARED BY ME OR UNDER MY DIRECT SUPERVISION AND THAT I AM A DULY LICENSED PROFESSIONAL ENGINEER UNDER THE LAWS OF THE STATE OF CO.

TRAVIS MOONEY  
DATE 07/10/2023 LICENSE NO. 0051259

VILLAGE CAMP DURANGO  
COUNTY ROAD 252 IMPROVEMENTS  
LA PLATA COUNTY, COLORADO

CONSTRUCTION NOTES

Save: 1/17/2025 1:01 PM cplister Plot: 1/17/2025 1:02 PM \\sehinc.com\parazura\projects\PT\ROBRE\168892\5-final-dsgn\51-drawings\10-Civilcad\dwg\sheet\_CR 252 Improvement\168892\_TS\_CR252.dwg

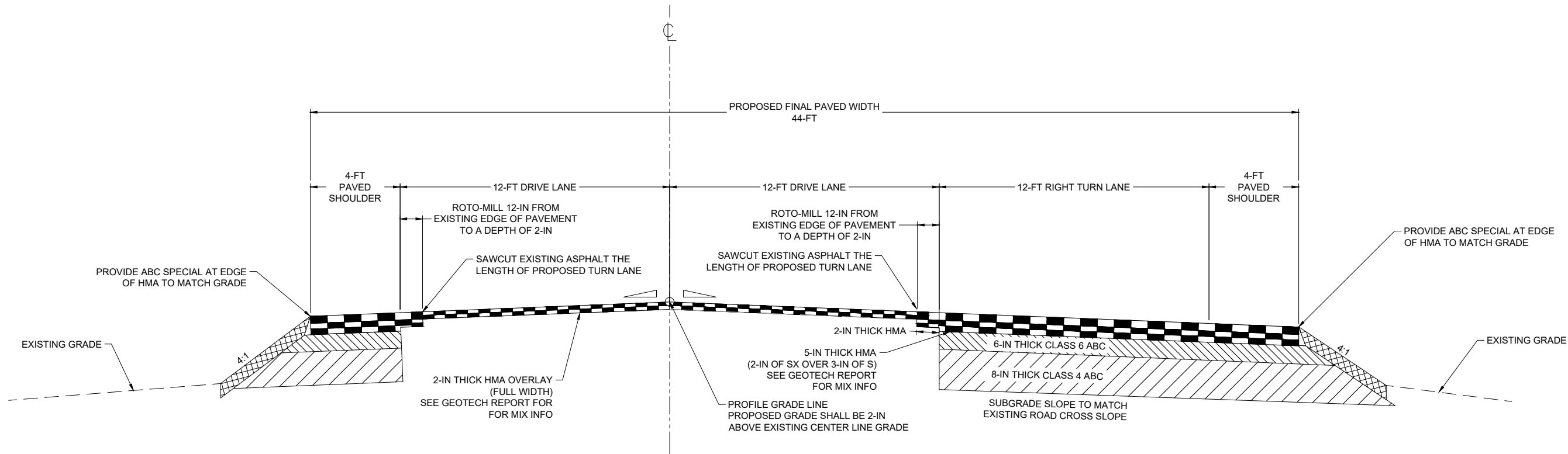

#### LEGEND

- ▲ - SAFETY EDGE WITH A 30°-35° SLOPE AND SHOULDER MATERIAL (SEE SAFETY EDGE DETAILS).
- ▴ - EXISTING SLOPE - IMPROVEMENTS TO MATCH EXISTING GRADE. MAX EX. SLOPE
- HMA - HOT MIX ASPHALT
- H.P. - HINGE POINT

### TYPICAL SECTION NOTES

- ALL SECTIONS ARE LOOKING STATION AHEAD.
- BREAK POINTS ON SLOPES AND BOTTOMS OF DITCHES SHALL BE ROUNDED DURING CONSTRUCTION FOR A PLEASING APPEARANCE. THERE SHALL NOT BE ANY PONDING IN DITCHES AFTER EARTHWORK IS COMPLETE.
- STEEPEN DITCH BACKSLOPES AS NECESSARY (1.5:1 MAXIMUM) TO STAY WITHIN EXISTING RIGHT-OF-WAY. USE THE FLATTER DITCH SLOPES WHEREVER POSSIBLE
- ALL ASPHALT SHALL BE GRADE SX.

#### TABULATION OF WIDTH

STATION	EXISTING ROAD	PROPOSED WIDENING
27+86	23.5	32.0
29+06	23.2	44.0
30+95	22.4	44.0
32+20	22.3	32.0
34+63	22.4	32.0
35+83	22.5	32.0
37+74	23.0	32.0
38+96	23.0	32.0

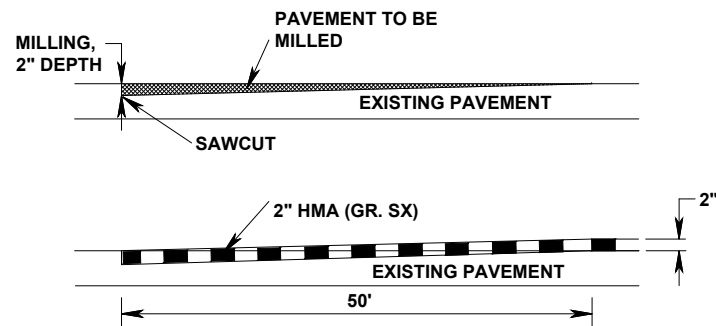

#### BUTT JOINT DETAIL N.T.S

- NOTES:
- CONSTRUCT PAVING NOTCH ACROSS ENTIRE ROADWAY AT THE LIMITS OF OVERLAYING.

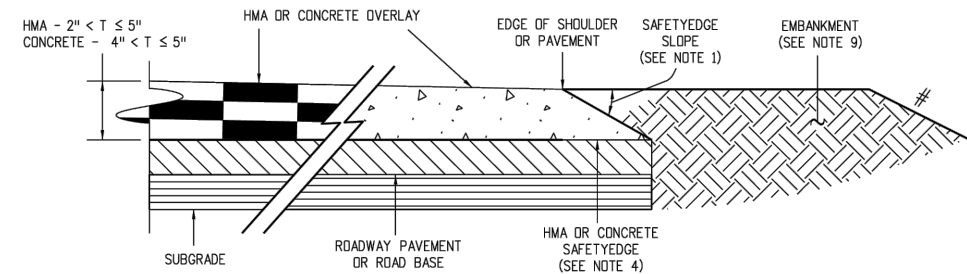

#### SAFETYEDGE DETAIL FOR NEW CONSTRUCTION, WIDENING, AND RECONSTRUCTION LESS THAN OR EQUAL TO 5 INCHES

#### SAFETY EDGE DETAIL N.T.S

- THE SAFETY EDGE WILL BE CONSTRUCTED AS PART OF THE ROADWAY PAVEMENT. A SHOULDER WEDGE DEVICE WILL BE ADDED TO THE SCREED OF THE PAVING MACHINE.
- THE CONTRACTOR MAY USE A SHOULDER WEDGE MAKER OR A SIMILAR DEVICE THAT PRODUCES THE SAME COMPACTION RESULTS.
- SHORT SECTIONS OF HANDWORK WILL BE ALLOWED WHEN NECESSARY FOR TRANSITIONS AND TURNOUTS.
- SITE PREPARATION AND ADDITIONAL EARTHWORK REQUIRED TO CONSTRUCT THE SAFETY EDGE WILL NOT BE PAID FOR SEPARATELY BUT SHALL BE INCLUDED IN THE WORK.



SURVEY DATA PROVIDED BY RED MOUNTAIN LAND SURVEY.  
CONTROL STATEMENT:  
HORIZONTAL CONTROL: MODIFIED STATE PLANE COORDINATE SYSTEM, COLORADO  
ZONE SOUTH WITH GROUND SCALE FACTOR OF 1.0003358386 ABOUT POINT # 100  
CPT1 BEING A SET 9-IN SPIKE.  
VERTICAL CONTROL: NAVD88, NCS BENCHMARK PID HL0370  
UNITS: US SURVEY FEET



END OF ALIGNMENT  
STATION=40+73.32  
N=1270048.34  
E=2321185.41

### GRADING LIMITS -

SEE SHEETS 9-11  
FOR PLAN AND PROFILES

EXISTING 80-FT R.O.W.

ROW (TYP.)

PT: 27+17.10

$$L=176.897, R=1282.038$$

SEE SHEET 3

10TH ROAD 1

DURANGO RIVER  
VIEW RV RESORT LLC  
PN: 559715100077

ANIMAS MOSQUITO  
CONTROL DISTRICT  
PN: 559715400074

4

Save: 1/17/2025 1:01 PM cplster Plot: 1/17/2025 1:02 PM \\sehinc.com\parazura\proj\projects\PT\ROBRE\168892\5-final-dsgn\51-drawings\10-Civil\cad\dwg\sheet\_CR 252 Improvement\168892\_ECP\_CR252.dwg

100 YEAR FLOOD WAY

100 YEAR FLOOD PLAIN

LEGEND

IMPERVIOUS (GRAVEL, ASPHALT)

VTP

EROSION LOGS OR STRAW BALES

SILT FENCE

LIMITS OF CONSTRUCTION

NOTES:

1. AREAS OF DISTURBANCE SHALL BE RESEEDED WITH NATIVE SEED MIX AND MULCHED, SEE BELOW.

2. ALL SLOPES STEEPER THAN 3:1 SHALL HAVE EROSION CONTROL FABRIC INSTALLED, UNLESS THE SLOPE IS A ROCK FACE.

3. ALL CONSTRUCTION BMPs SHALL BE INSTALLED AND MAINTAINED BY THE CONTRACTOR.

4. SURFACE ROUGHENING SHALL BE UTILIZED ON ALL DIRT AREAS AND SLOPES.

5. ALL DISTURBED AREAS SHALL BE MULCHED IN ACCORDANCE WITH THE LA PLATA COUNTY LAND USE CODE, CHAPTER 70 - GENERAL SITE DEVELOPMENT STANDARDS AND CDOT SPECIFICATIONS SECTION 213.

NATIVE SEED MIX:

COMMON NAME	BOTANICAL NAME	LBS. PLS PER ACRE
Western Wheatgrass (V. Arriba)	Pascopyrum Smithii	16
Slender Wheatgrass (V. San Luis)	Elymus Trachycaulus	6
Indian Ricegrass (V. Paloma)	Oryzopsis Hymenoides	6
Hard Fescue (V. Durar)	Festuca Ovina Duriuscula	6
Alsike Clover	Trifolium Hybridum	4
Sand Dropseed	Sporobolul Cryptandrus	0.5
TOTAL		38.5

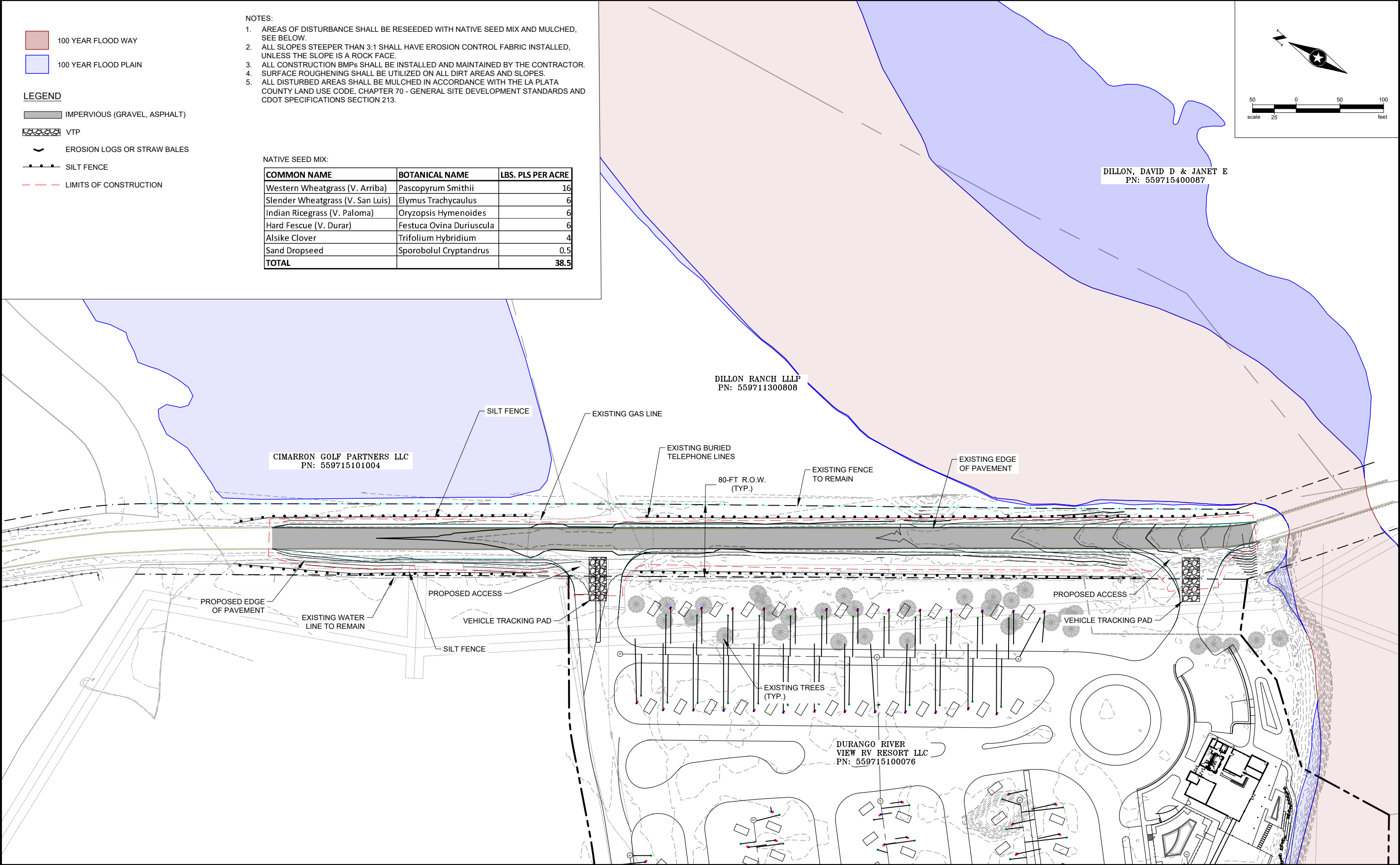
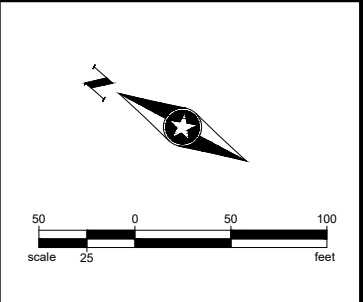

Save: 1/17/2025 1:01 PM cplister Plot: 1/17/2025 1:02 PM \\sehinc.com\panzura\p2projects\PT\ROBRE\168892\5-final-dsgn\51-drawings\10-Civil\cad\dwg\sheet\_CR 252 Improvement\168892\_PP\_CR252.dwg

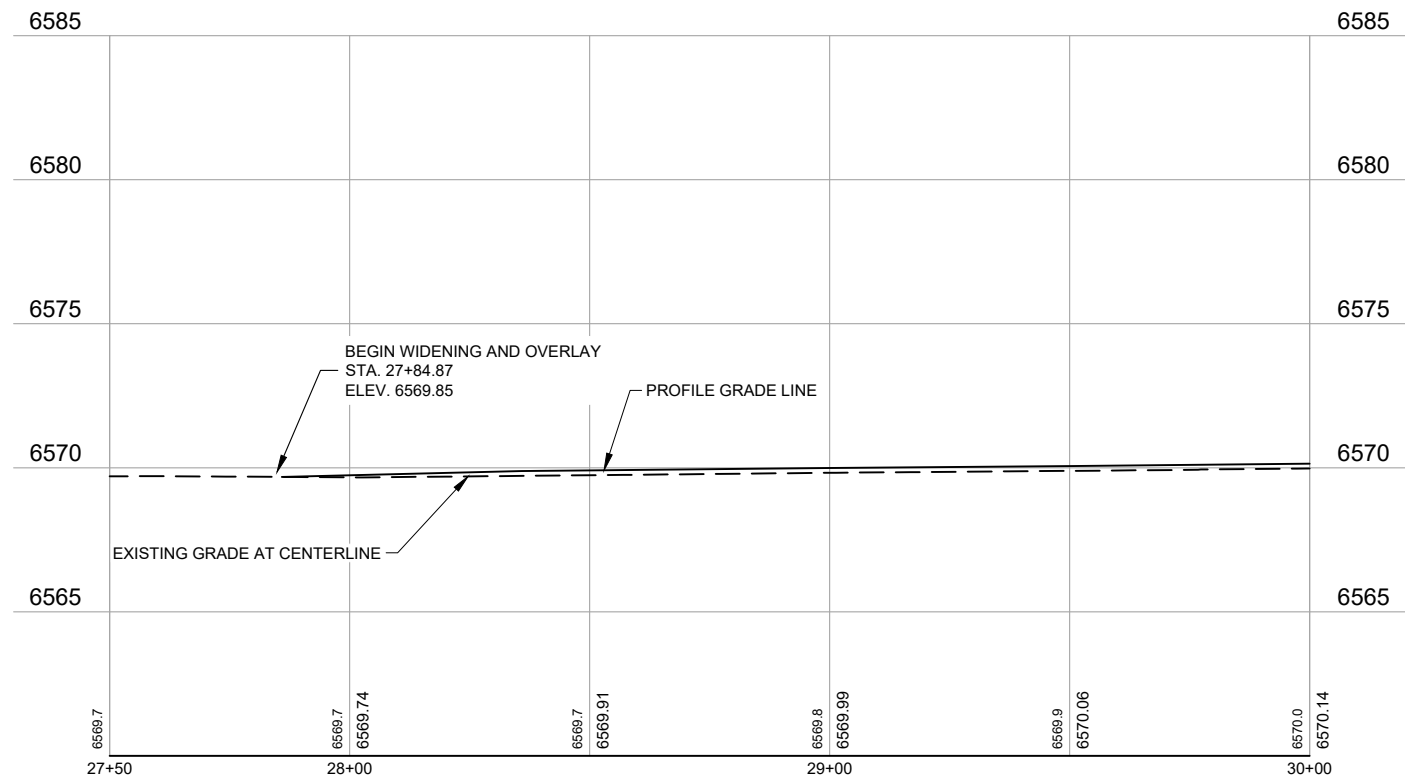
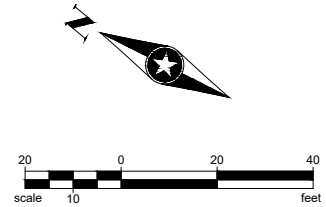
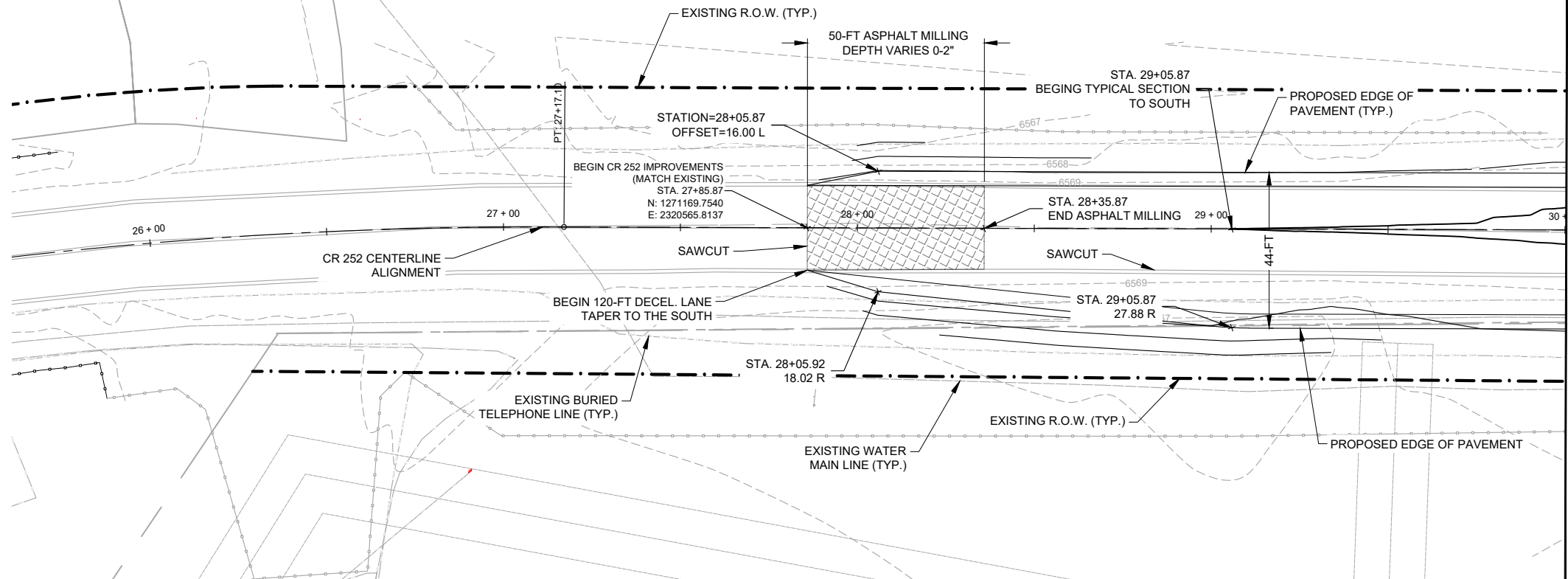

SEH Project	168892	Rev #	Revision Issue Description	Date	Rev.#	Revision Issue Description	Date
Drawn By	SC/CM	##	##	##	##	##	##
Designed By	DP	##	##	##	##	##	##
Checked By	SW	##	##	##	##	##	##



I HEREBY CERTIFY THAT THIS PLAN WAS PREPARED BY ME OR UNDER MY DIRECT SUPERVISION AND THAT I AM A DULY LICENSED PROFESSIONAL ENGINEER UNDER THE LAWS OF THE STATE OF CO.

TRAVIS MOONEY  
DATE 07/10/2023  
LICENSE NO. 0051259

VILLAGE CAMP DURANGO  
COUNTY ROAD 252 IMPROVEMENTS  
LA PLATA COUNTY, COLORADO

PPRO STA 26+50 TO STA 30+00 A









Save: 1/17/2025 1:01 PM cplster Plot: 1/17/2025 1:02 PM \\sehinc.com\parazura\p2projects\PT\ROBRE\168892\5-final-dsgn\51-drawings\10-Civil\cad\dwg\sheet\_CR 252 Improvement\168892\_SS\_CR252.dwg

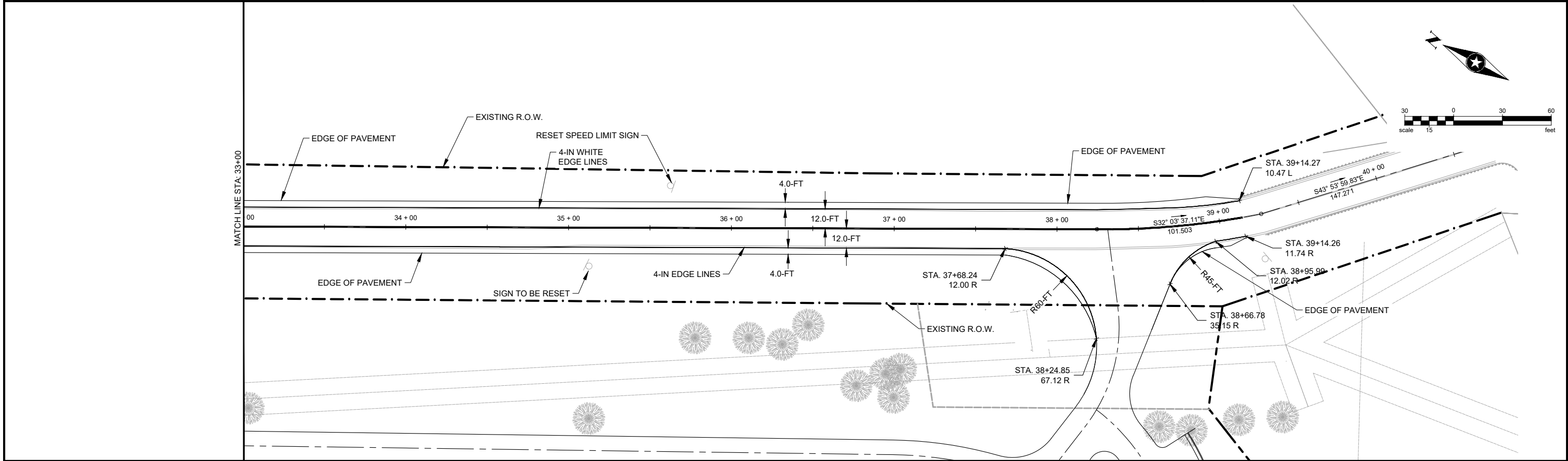
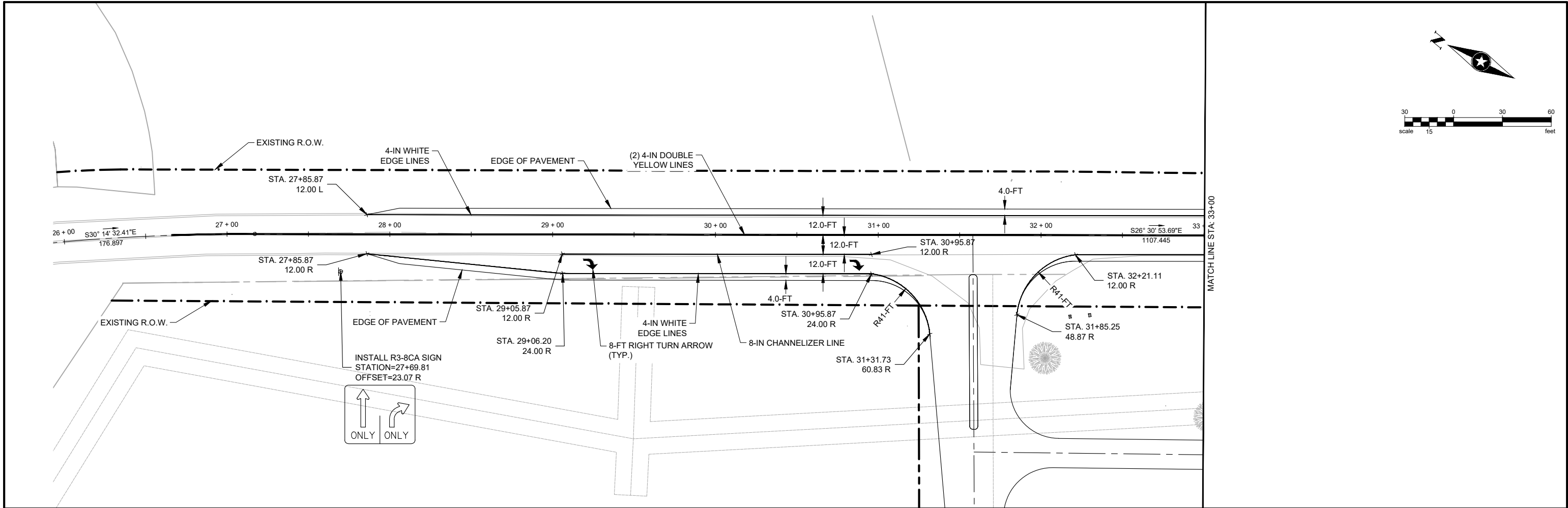

Save: 1/17/2025 10:58 AM, cplstier Plot: 1/17/2025 1:02 PM, lsehinc.com\panzuraj\projects\PT\TRORORE\168892\5-final-dsrm\51-drawings\10-Civil\cadd\cvo\sheet CR 252 Improvement\XS 168892\_CR252.dwg

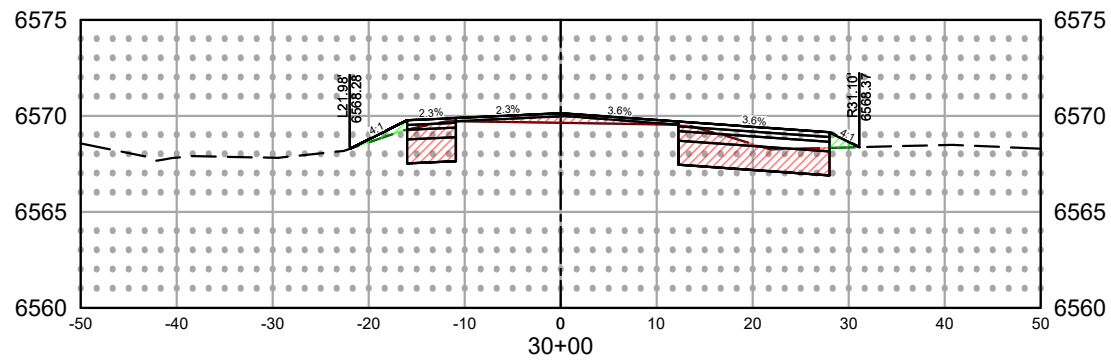
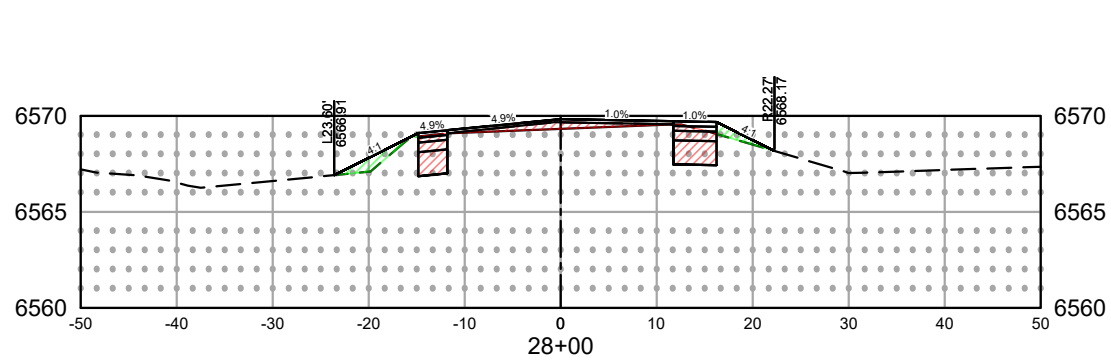
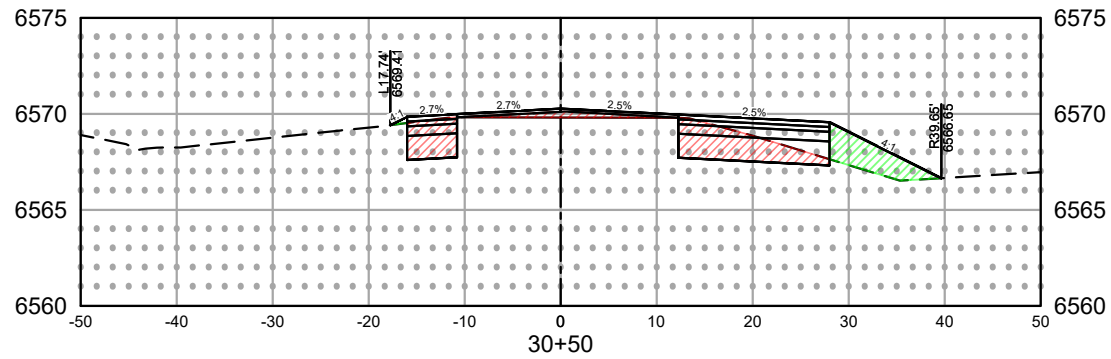
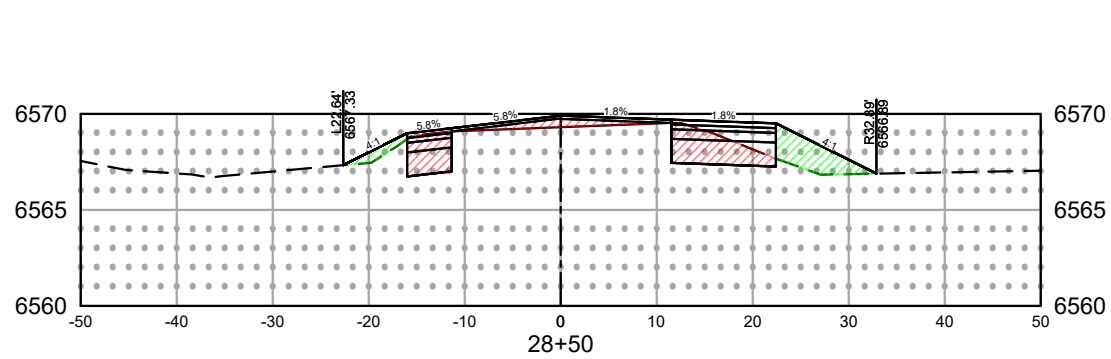
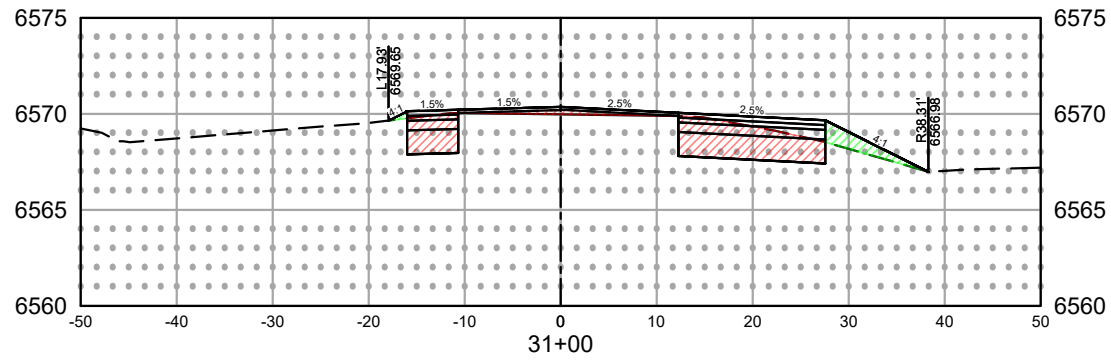
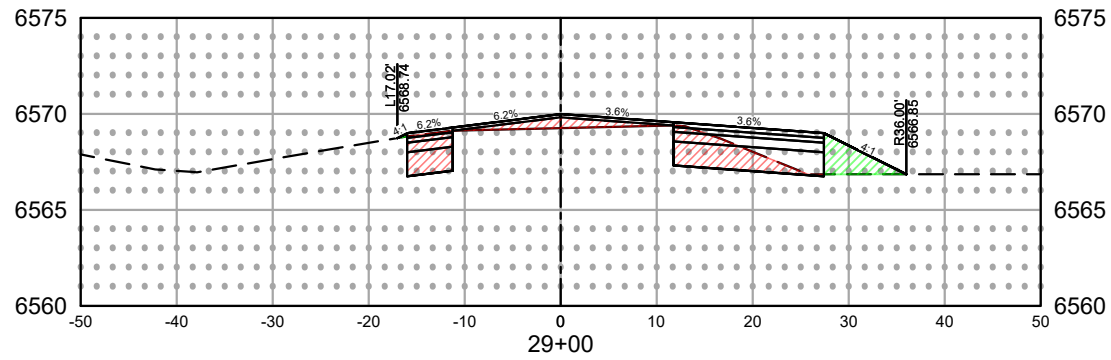
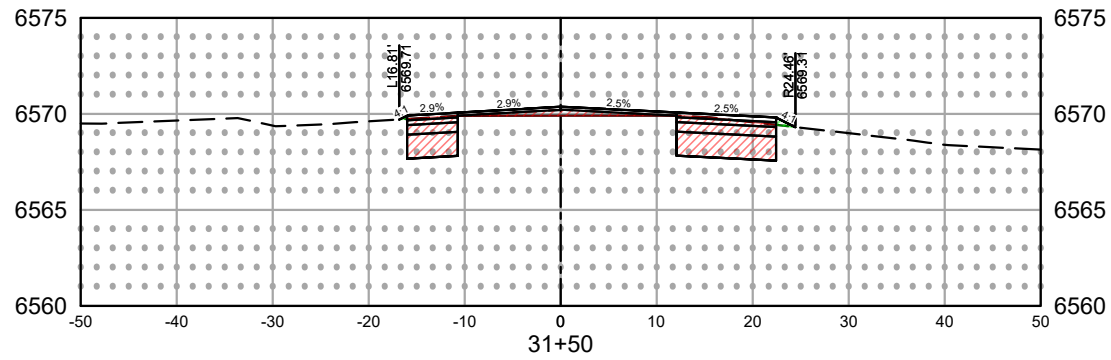
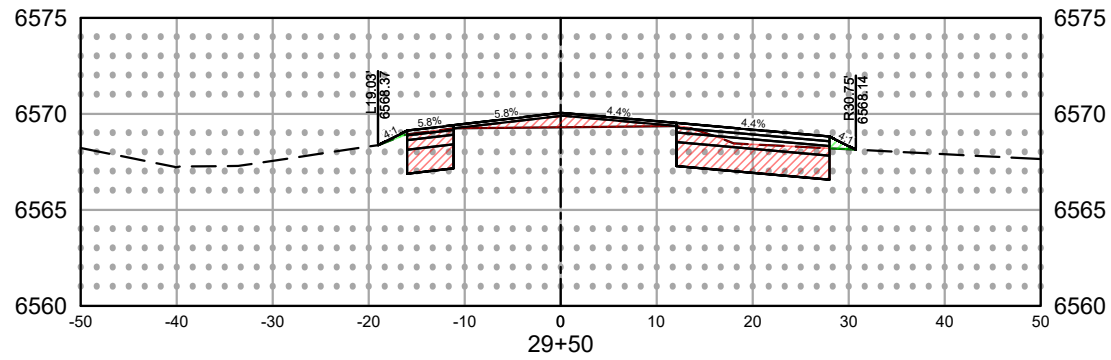

SEH Project	168892	Rev.#	Revision Issue Description	Date	Rev.#	Revision Issue Description	Date
Drawn By	SC/CM				##	##	##
Designed By	DP				##	##	##
Checked By	SW				##	##	##

I HEREBY CERTIFY THAT THIS PLAN WAS PREPARED BY ME OR UNDER MY DIRECT SUPERVISION AND THAT I AM A DULY LICENSED PROFESSIONAL ENGINEER UNDER THE LAWS OF THE STATE OF CO.

TRAVIS MOONEY  
DATE 07/10/2023  
LICENSE NO. 0051259

VILLAGE CAMP DURANGO  
COUNTY ROAD 252 IMPROVEMENTS  
LA PLATA COUNTY, COLORADO

CROSS SECTIONS A

Save: 1/17/2025 10:58 AM: cplstter Plot: 1/17/2025 1:02 PM: lsehinc.com\panzurap\projects\PT\TRORBRE\168892\5-final-dgn\51-drawings\10-Civil\cadd\vg\sheet\_CR 252 Improvement\XS\_168892\_CR252.dwg

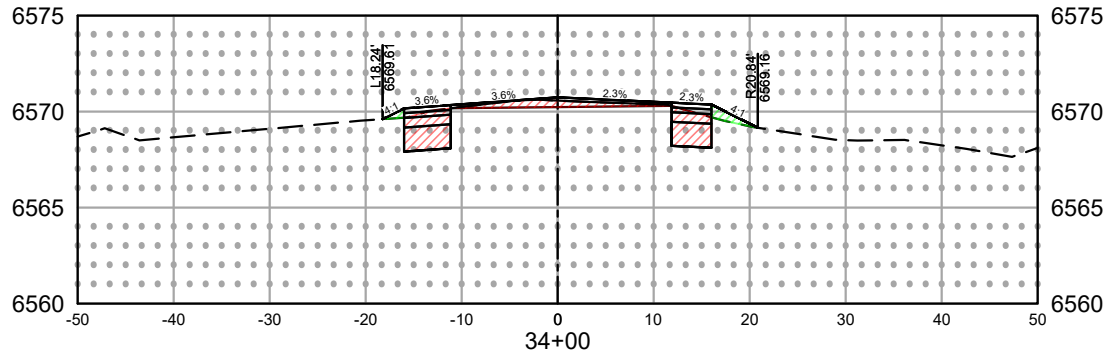
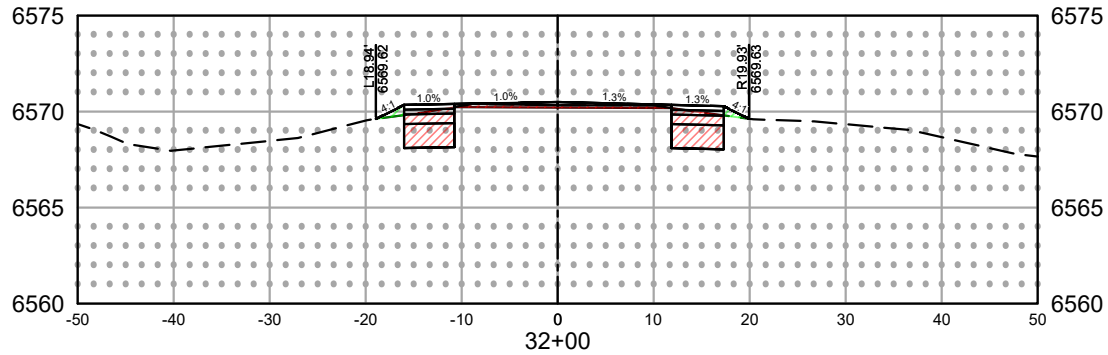
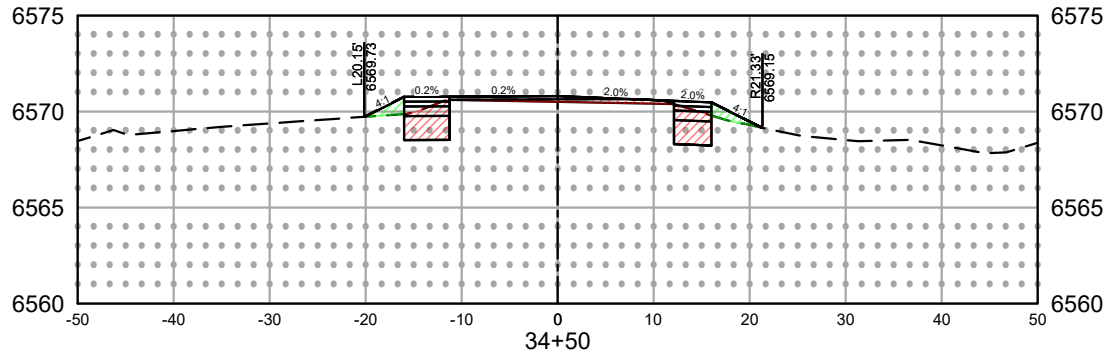
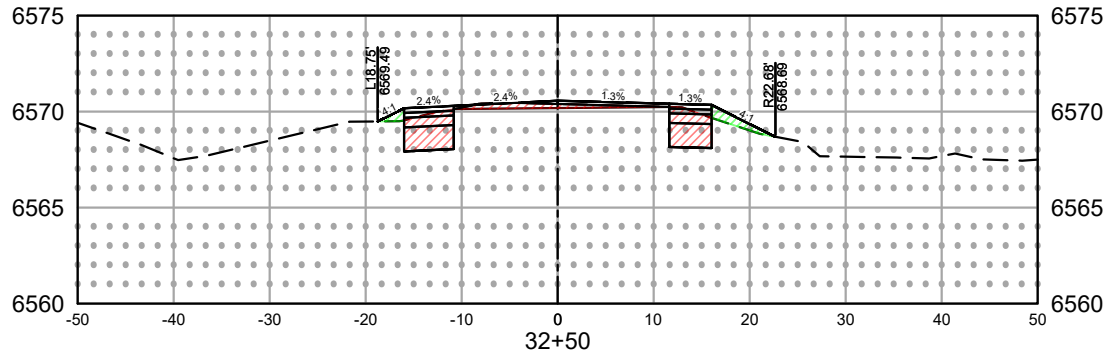
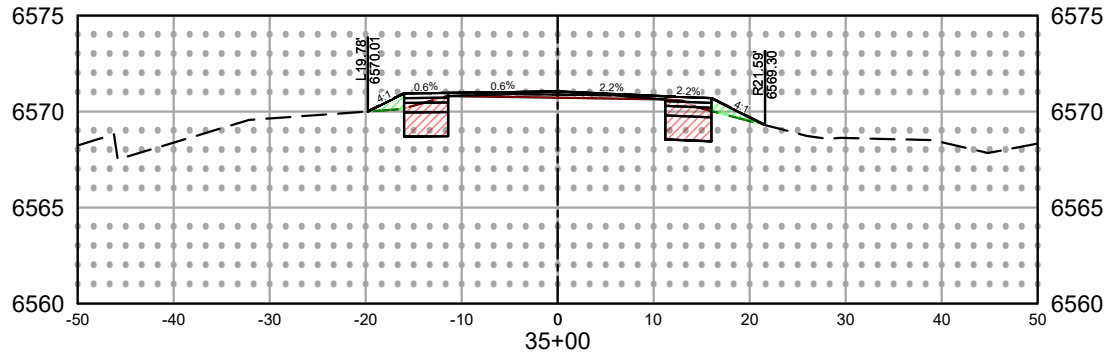
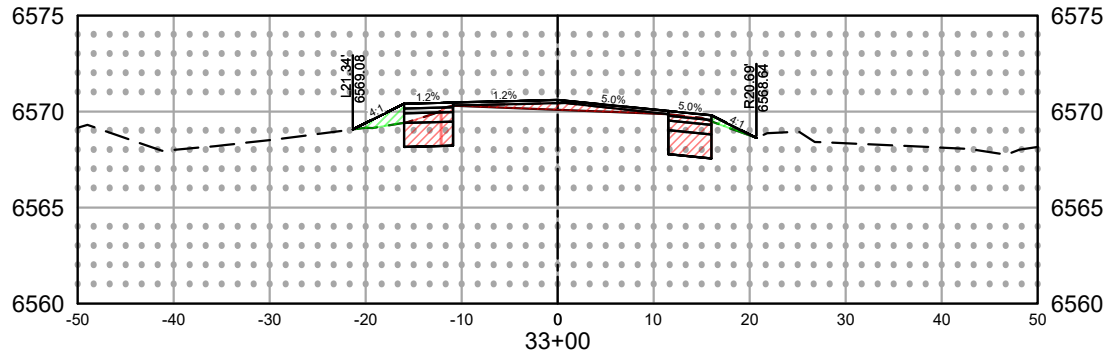
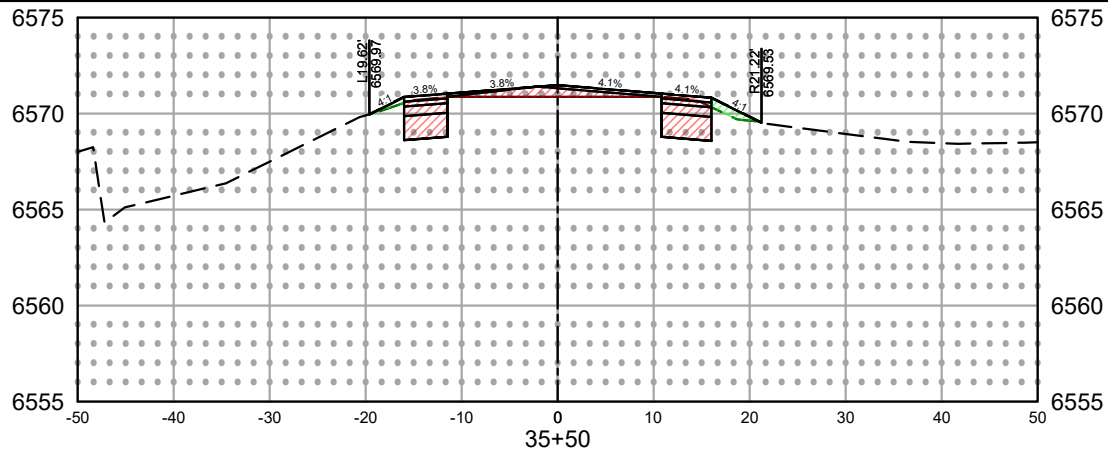
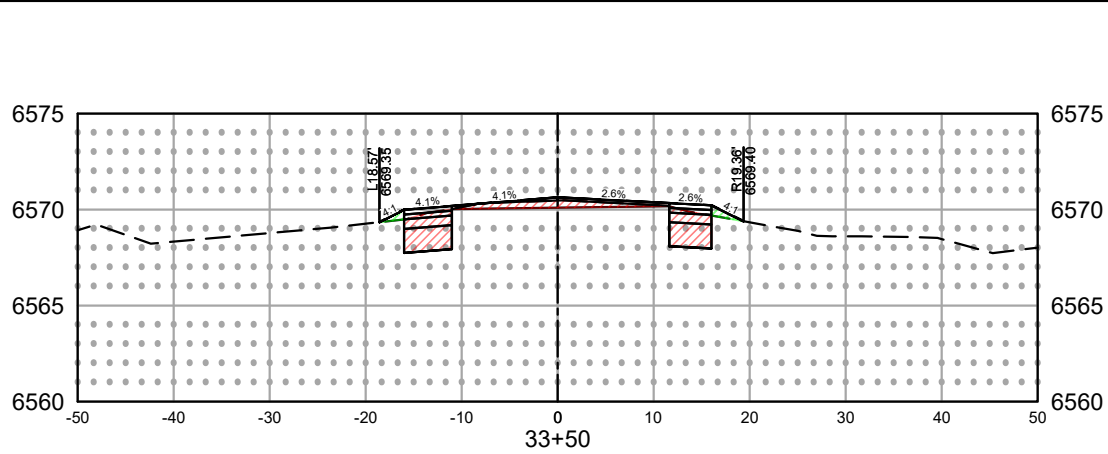

SEH Project 168892  
Drawn By SC/CM  
Designed By DP  
Checked By SW

Rev.#	Revision Issue Description	Date
##	##	##
##	##	##
##	##	##

Rev.#	Revision Issue Description	Date
##	##	##
##	##	##
##	##	##



I HEREBY CERTIFY THAT THIS PLAN WAS PREPARED BY ME OR UNDER MY DIRECT SUPERVISION AND THAT I AM A DULY LICENSED PROFESSIONAL ENGINEER UNDER THE LAWS OF THE STATE OF CO.

TRAVIS MOONEY  
DATE 07/10/2023

LICENSE NO. 0051259

VILLAGE CAMP DURANGO  
COUNTY ROAD 252 IMPROVEMENTS  
LA PLATA COUNTY, COLORADO

CROSS SECTIONS B

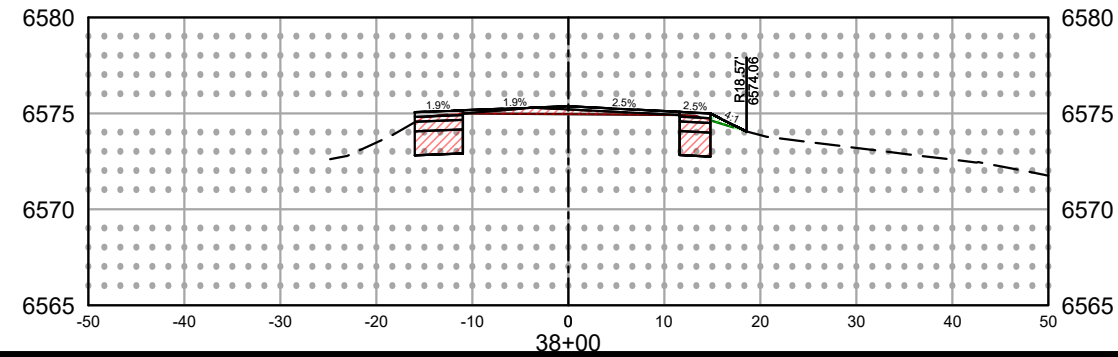
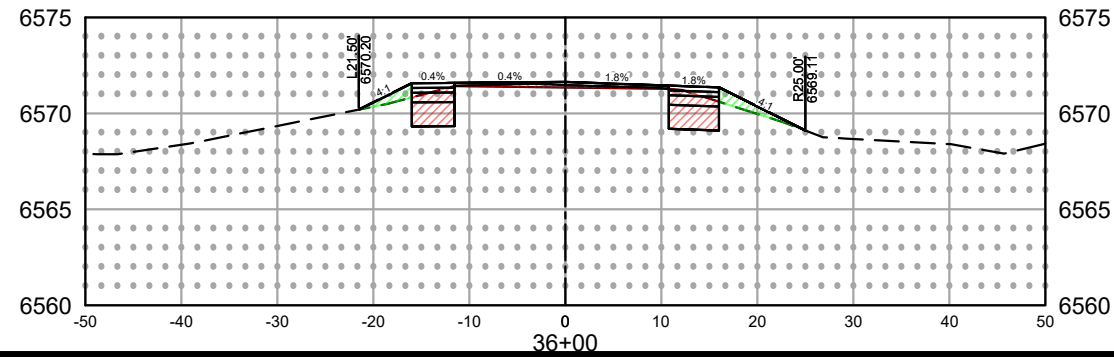
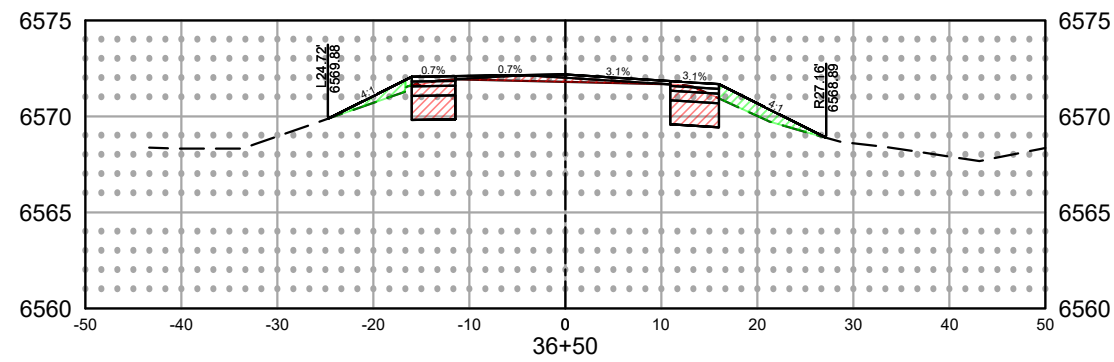
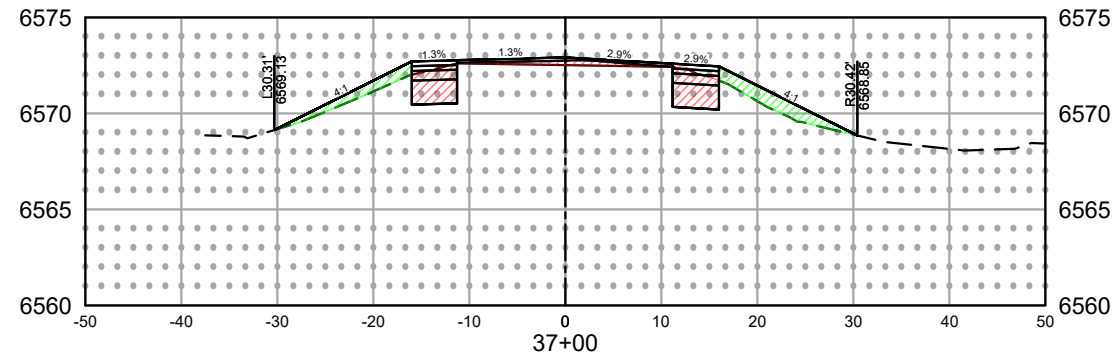
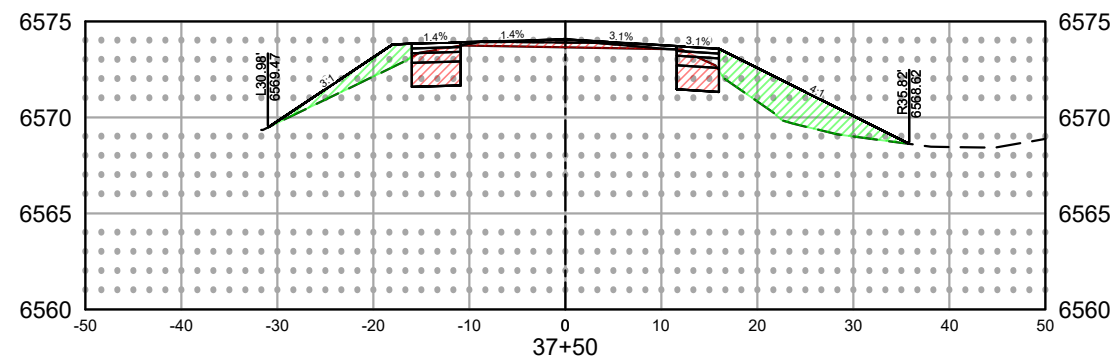

SEH Project	168892	Rev.#	Revision Issue Description	Date	Rev.#	Revision Issue Description	Date
Drawn By	SC/CM				##	##	##
Designed By	DP				##	##	##
Checked By	SW				##	##	##



I HEREBY CERTIFY THAT THIS PLAN WAS PREPARED BY ME OR UNDER MY DIRECT SUPERVISION AND THAT I AM A DULY LICENSED PROFESSIONAL ENGINEER UNDER THE LAWS OF THE STATE OF CO.

---

TRAVIS MOONEY		
DATE	07/10/2023	LICENSE NO. 0051259

VILLAGE CAMP DURANGO  
COUNTY ROAD 252 IMPROVEMENTS  
LA PLATA COUNTY, COLORADO